

ClamPro®



HAND RIVETER WITH STEM COLLECTION TANK MODEL NO: CHT878

PART NO: 1801878

USER INSTRUCTIONS

ORIGINAL INSTRUCTIONS

GC0518 ISS 1

INTRODUCTION

Thank you for purchasing this CLARKE Hand Riveter with stem collection tank. Before attempting to use this product, please read this manual thoroughly and follow the instructions carefully. In doing so you will ensure the safety of yourself and that of others around you and you can look forward to your purchase giving you long and satisfactory service.

GUARANTEE

This product is guaranteed against faulty manufacture for a period of 12 months from the date of purchase. Please keep your receipt which will be required as proof of purchase.

This guarantee is invalid if the product is found to have been abused or tampered with in any way, or not used for the purpose for which it was intended.

Faulty goods should be returned to their place of purchase, no product can be returned to us without prior permission. This guarantee does not effect your statutory rights.

FITTING AND STORING THE NOZZLES

Choose the rivet to be used for the job. The CHT878 Hand Riveter is equipped with a choice of 5 different size nozzles to suit different rivets.

The sizes available are:

- 3/32" (2.4 mm)
- 1/8" (3.2 mm)
- 5/32" (4.0 mm)
- 3/16" (4.8 mm)
- 1/4" (6.4 mm)

NOTE: The dimensions are engraved on each one.

- Always store the unused nozzles by screwing them back into the stem collector of the riveter for safe keeping.

Screw your chosen nozzle into the tip of the rivet gun, finger tight.

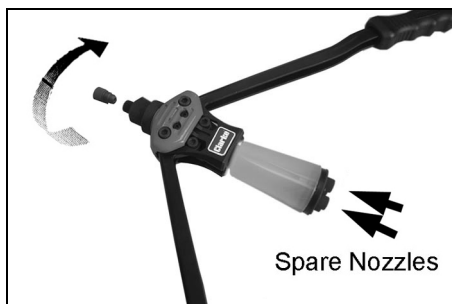

OPERATION

1. When items are to be riveted together, the hole diameter must be nominally larger than the outer diameter of the rivet. Ensure the hole is perpendicular with the surface of the workpiece components.
2. Insert the rivet into the hole in the workpiece.
3. Open the arms of the riveter as wide as possible.
 - This will enable you to insert the rivet stem into the riveter as far as it will go.
4. Ensure that the riveter is perpendicular to the workpiece and the flange of the rivet is pressed against it.
5. Close the handles together to expand the rivet.
6. If the rivet stem does not break at the first stroke, open the handles and repeat until the components are squeezed tightly together and the rivet stem breaks off.
7. The broken stem should be ejected from the nozzle and be caught in the collection tank.
8. Unscrew the collection tank and dispose of the contents when full.

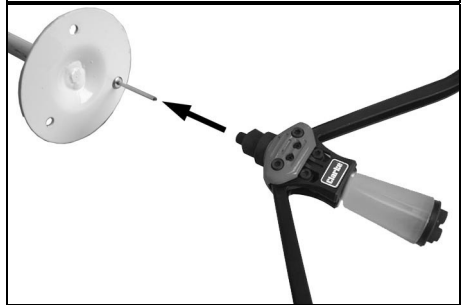
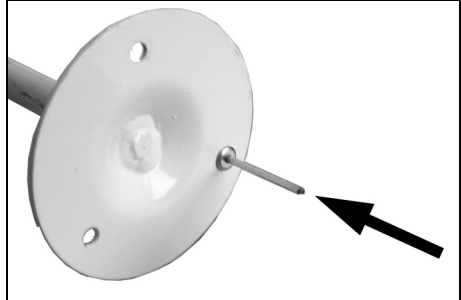

ADJUSTMENT

If the internal claws of the rivet gun fail to grip the stem of the rivet, the riveter will need adjusting.

1. Loosen the locking nut and rotate the riveter shield clockwise to tighten (anti-clockwise to loosen).
2. Open the handles to relax the riveter and to tighten the internal claws.
3. Re-tighten the locking nut.

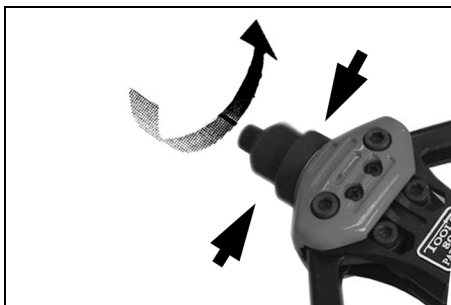

A SELECTION FROM THE VAST RANGE OF

Clarke®

QUALITY PRODUCTS

AIR COMPRESSORS

From DIY to industrial, Plus air tools, spray guns and accessories.

GENERATORS

Prime duty or emergency standby for business, home and leisure.

POWER WASHERS

Hot and cold, electric and engine driven - we have what you need

WELDERS

Mig, Arc, Tig and Spot. From DIY to auto/industrial.

METALWORKING

Drills, grinders and saws for DIY and professional use.

WOODWORKING

Saws, sanders, lathes, mortisers and dust extraction.

HYDRAULICS

Cranes, body repair kits, transmission jacks for all types of workshop use.

WATER PUMPS

Submersible, electric and engine driven for DIY, agriculture and industry.

POWER TOOLS

Angle grinders, cordless drill sets, saws and sanders.

STARTERS/CHARGERS

All sizes for car and commercial use.

PARTS & SERVICE: 020 8988 7400

E-mail: Parts@clarkeinternational.com or Service@clarkeinternational.com

SALES: UK 01992 565333 OR Export 00 44 (0) 01992 565335

Clarke® INTERNATIONAL Hemnall Street, Epping, Essex CM16 6DB
www.clarkinternational.com